

If I am unable to help myself, please follow the instructions inside this leaflet to give me an injection of adrenaline. To do this you will need to use my Jext®. Dial 999 in UK or 112 in Ireland, ask for an ambulance and say "anaphylaxis". Location of Jext®: Name: Jext of kin/emergency contact name and phone number:

Suspected Adverse Drug Reactions (side effects) or medication errors may be reported using the Medicines Authority ADR reporting form, which is available online at <http://www.medicinesauthority.gov.mt/adrportal>, and sent by post or email to; P: Pharmacovigilance Section at Post-Licensing Directorate, Medicines Authority, Sir Temi Żammit Buildings, Malta Life Sciences Park, San Ġwann SGN 3000 E: postlicensing.medicinesauthority@gov.mt ADRs may also be reported at JV Healthcare Limited, Navi Buildings, Pantar Road, Lija LJA 2021, E: info@jvpharma.eu

- A Jext® trainer is available for you to practise using Jext® in an emergency
- Visit www.jext.co.uk or www.jext.ie and register for a free expiry alert and other support materials
- Text Alert **MMYYYY** (e.g. text Alert **072023** if your Jext® expires in July 2023) to **80818**

Symptoms of Anaphylaxis

- Tightening of the throat/difficulty breathing
- Collapse/loss of consciousness
- Itchy hives
- Tingling and swelling of hands/feet/eyelids/mouth/lips/genitals
- Sense of impending doom

Remember it is important to make sure your Jext® is within the expiry date

Ensure you, your child, your family and friends know how and when to use your Jext®

Video demonstrations can be found at www.jext.co.uk or www.jext.ie

lifeline

lifetime care and support in anaphylaxis



Jext® 300 micrograms: patients greater than 30kg

Jext® 150 micrograms: patients 15 - 30kg

www.jext.co.uk
www.jext.ie

LIFELINE CARD

Emergency information about how and when to use Jext®
www.jext.co.uk / www.jext.ie



Active ingredient - Adrenaline (as tartrate)

Instructions For Use



Step 1

Grasp the Jext® injector in your dominant hand (the one you use to write with) with your thumb closest to the yellow cap.

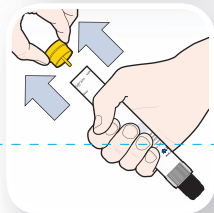

Step 2

Pull off the yellow cap with your other hand.



Step 3

Place the black injector tip against your outer thigh, holding the injector at a right angle (approx 90°) to the thigh.



Step 4

Push the black tip firmly into your outer thigh until you hear a 'click' confirming the injection has started, then keep it pushed in. Hold the injector firmly in place against the thigh for 10 seconds (a slow count to 10) then remove. The black tip will extend automatically and hide the needle.



Step 5

Massage the injection area for 10 seconds. Seek immediate medical help.

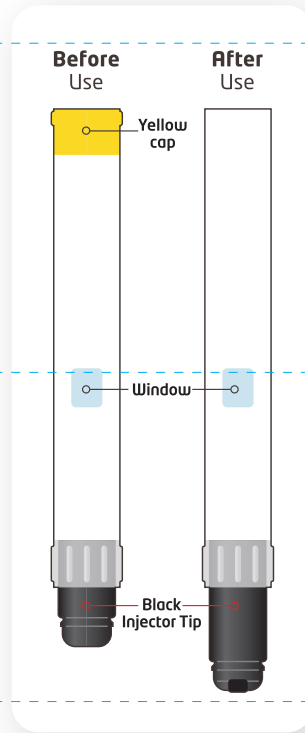

Treatment Quick Guide

ANAPHYLAXIS

Use your Jext® and immediately after using your Jext® dial 999, or 112 in Ireland, ask for an ambulance and say "anaphylaxis"



Be prepared:

Use a second Jext® after 5-15 minutes if the symptoms do not improve

www.jext.co.uk
www.jext.ie

Don't forget to download the app for Jext® patient support



SCAN ME

Dial 999 in UK or 112 in Ireland, ask for an ambulance and say "anaphylaxis".

If you are unable to make the call, get someone else to call for you.

MAKE SURE YOU CARRY TWO JEXT® PENS WITH YOU AT ALL TIMES IN CASE YOU NEED A SECOND DOSE.

