

Fold



Talk to your doctor before you are given Remsima® if you have:

1. Had treatment with Infiximab product before:

Tell your doctor if you have had treatment with Infiximab in the past.

2. Infections:

Tell your doctor straight away if you get symptoms of infection during treatment with Remsima®. Symptoms include a fever, feeling tired, (persistent) cough, shortness of breath, weight loss, night sweats, diarrhea, wounds, dental problems, burning when urinating or 'flu-like' symptoms.

Infusion Card

8 Weekly Treatment

Remsima®

▼ This medicine is subject to additional monitoring. This will allow quick identification of new safety information. You can help by reporting any side effects you may get.



Fold

Remsima® Infusion Card

<input checked="" type="checkbox"/>	<input type="checkbox"/>	<input type="checkbox"/>		<input type="checkbox"/>
1.	2.	3.		4.
0 week	2 week	6 week	after 3rd Infusion	every 8 week
Date:	Date:	Date:		Date:
Brand Name:	Brand Name:	Brand Name:		Brand Name:
Batch No.:	Batch No.:	Batch No.:		Batch No.:
<input type="checkbox"/>	<input type="checkbox"/>	<input type="checkbox"/>	<input type="checkbox"/>	<input type="checkbox"/>
8.	7.	6.		5.
every 8 week	every 8 week	every 8 week	every 8 week	every 8 week
Date:	Date:	Date:		Date:
Brand Name:	Brand Name:	Brand Name:		Brand Name:
Batch No.:	Batch No.:	Batch No.:		Batch No.:

* If you forget or miss an appointment to receive Remsima®, make another appointment as soon as possible. If you have any further questions on the use of this medicine, ask your doctor.

Fold



Talk to your doctor before you are given Remsima® if you have:

1. Had treatment with Infiximab product before:

Tell your doctor if you have had treatment with Infiximab in the past.

2. Infections:

Tell your doctor straight away if you get symptoms of infection during treatment with Remsima®. Symptoms include a fever, feeling tired, (persistent) cough, shortness of breath, weight loss, night sweats, diarrhea, wounds, dental problems, burning when urinating or 'flu-like' symptoms.

Infusion Card

6-8 Weekly Treatment

Remsima®

▼ This medicine is subject to additional monitoring. This will allow quick identification of new safety information. You can help by reporting any side effects you may get.



Fold

Remsima® Infusion Card



1.



2.

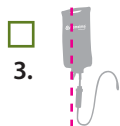

3.

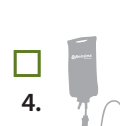

4.

0 week

2 week

.....

6 week

after 3rd Infusion

every 6-8

Date:

Brand Name:

Batch No.:

Date:

Brand Name:

Batch No.:

Date:

Brand Name:

Batch No.:

Date:

Brand Name:

Batch No.:



8.



7.

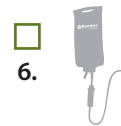

6.

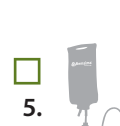

5.

every 6-8 week

every 6-8 week

every 6-8 week

every 6-8

Date:

Brand Name:

Batch No.:

Date:

Brand Name:

Batch No.:

Date:

Brand Name:

Batch No.:

Date:

Brand Name:

Batch No.:

* If you forget or miss an appointment to receive Remsima®, make another appointment as soon as possible. If you have any further questions on the use of this medicine, ask your doctor.